

JOSEPH

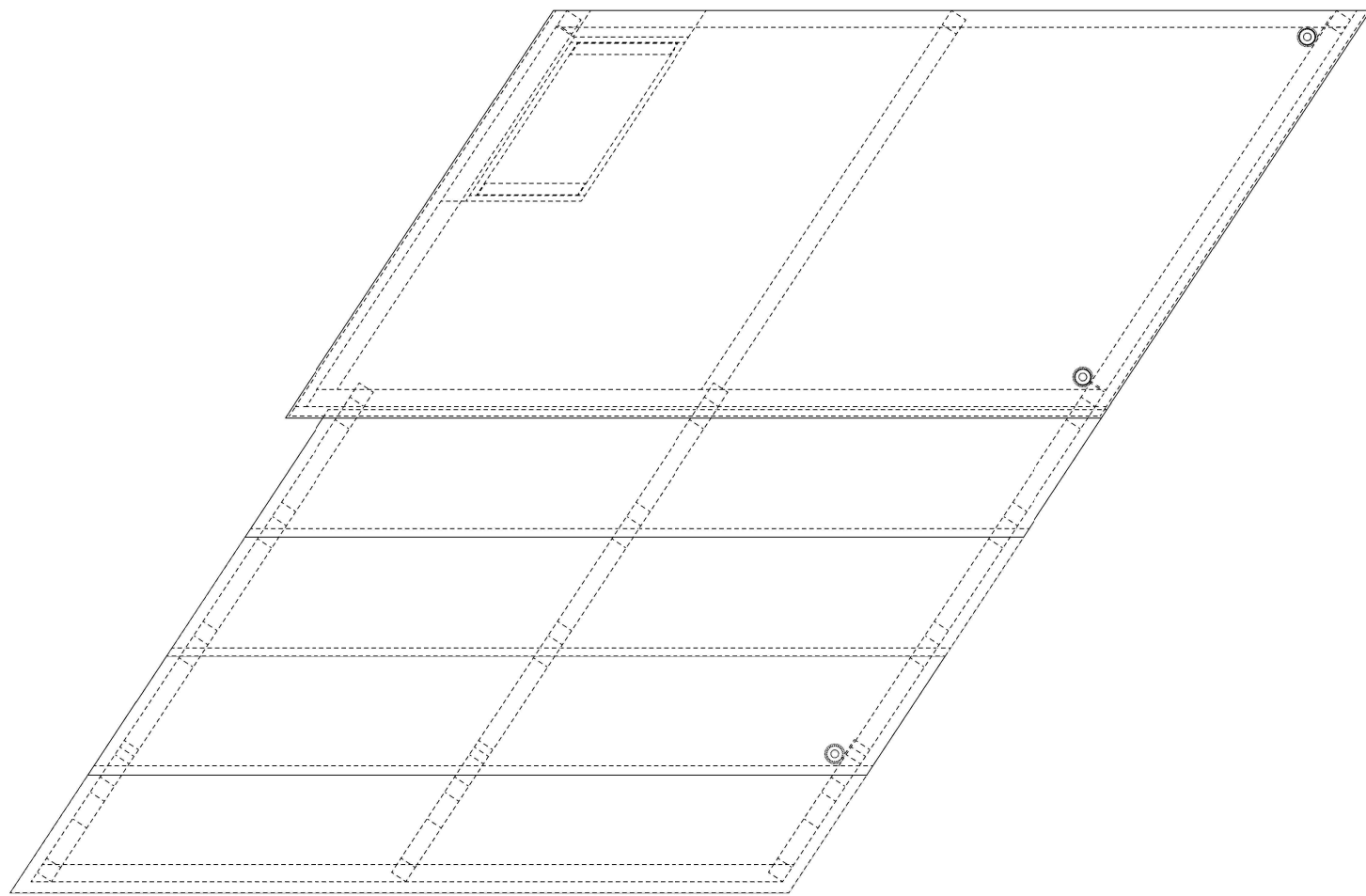

1 TOP VIEW
100 1.5"x.065 SQ TUBE CONST.
2"x12" TREADS
3/4" PLY LID WITH MASO SKIN ON TOP PLATFORM
CARPET STAPLED TO THE BOTTOM FOR MOBILITY
BUILD 2 (R & R) 3/4" = 1'

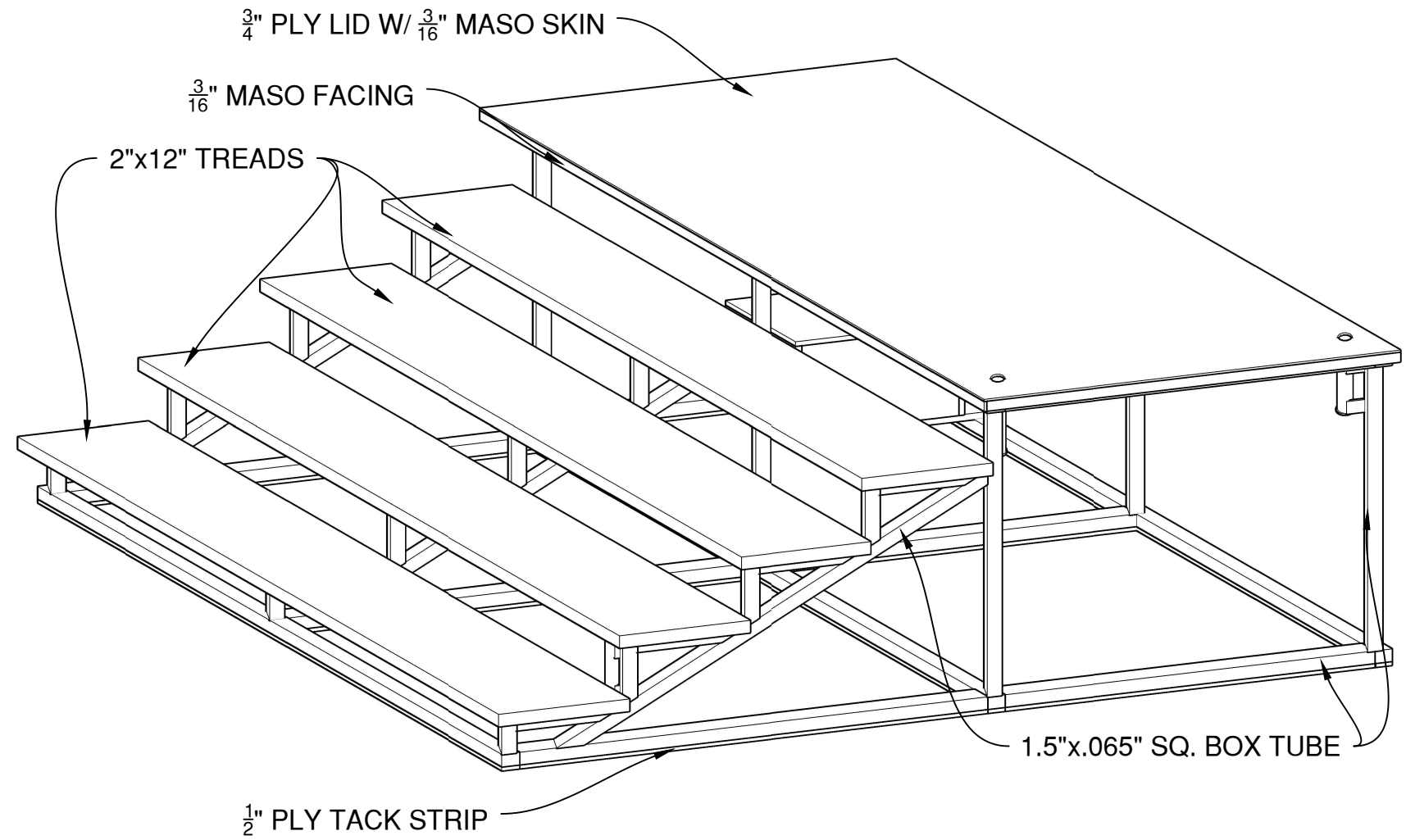

3 RIGHT FRONT ISO VIEW
100 3/4" = 1'

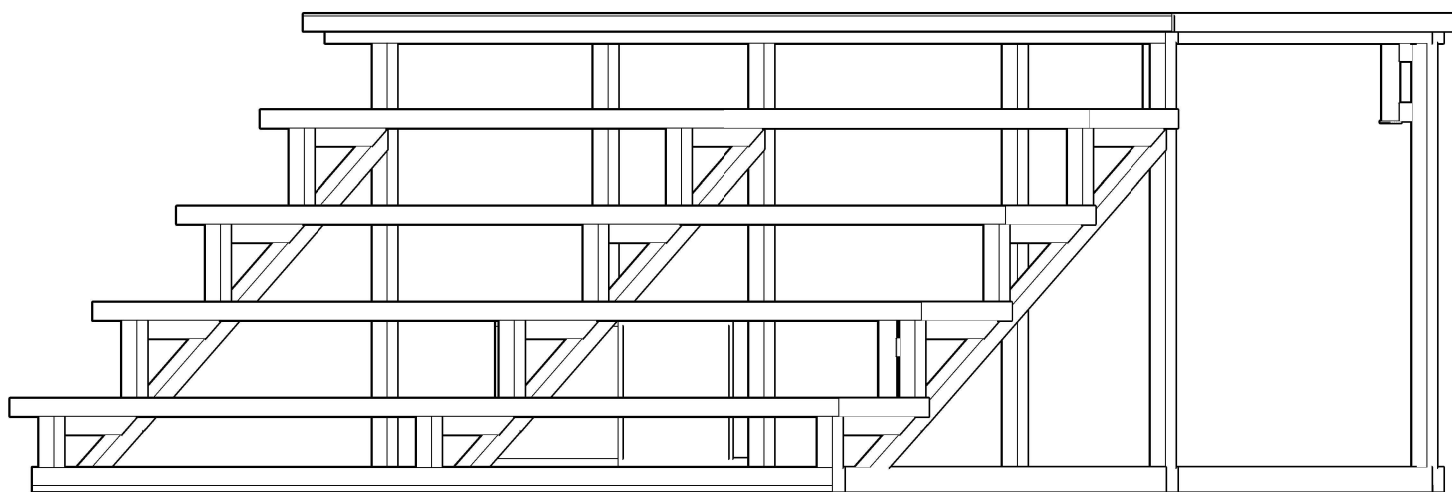

2 FRONT VIEW
100 3/4" = 1'

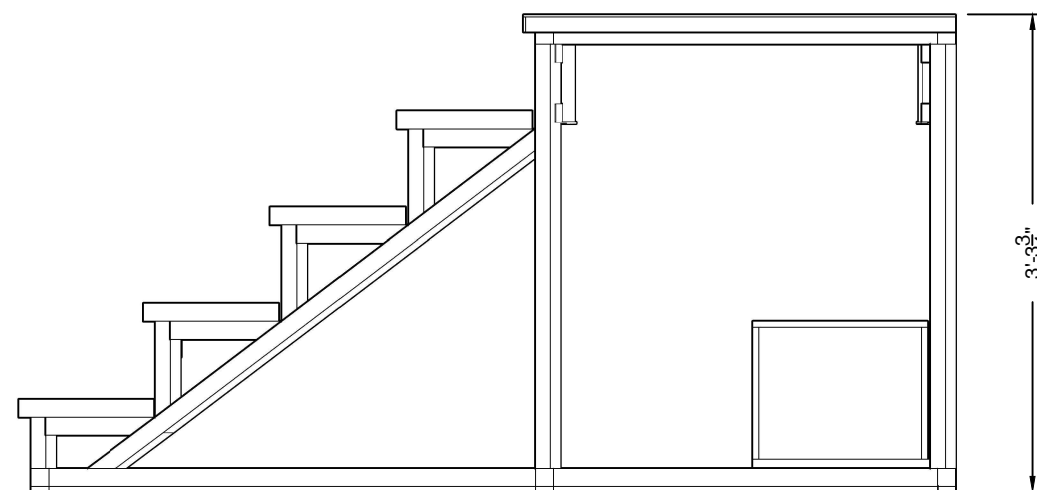

4 SIDE VIEW
100 FINISHED HEIGHT SHOULD BE 3'-4"
1/4" RESERVED FOR CARPET THICKNESS 3/4" = 1'

DS STAIRS

OVERVIEW

DIRECTOR:	BRAD CARROL
DESIGNER:	JASON LAJKA
TECH DIRECTOR:	T. FAGERHOLM
DWG BY:	MDB
DATE:	4/29/2019
INVENTORY CODE:	JO - DSS
FILE:	JO- 100- DS STAIRS

BUILD TIME

DATE	HOURS (Closest 1/2 hour)

MATERIALS USED

MATERIAL	QUANTITY

SCRAP USED

MATERIAL	QUANTITY

SCALE: AS NOTED

100

JOSEPH

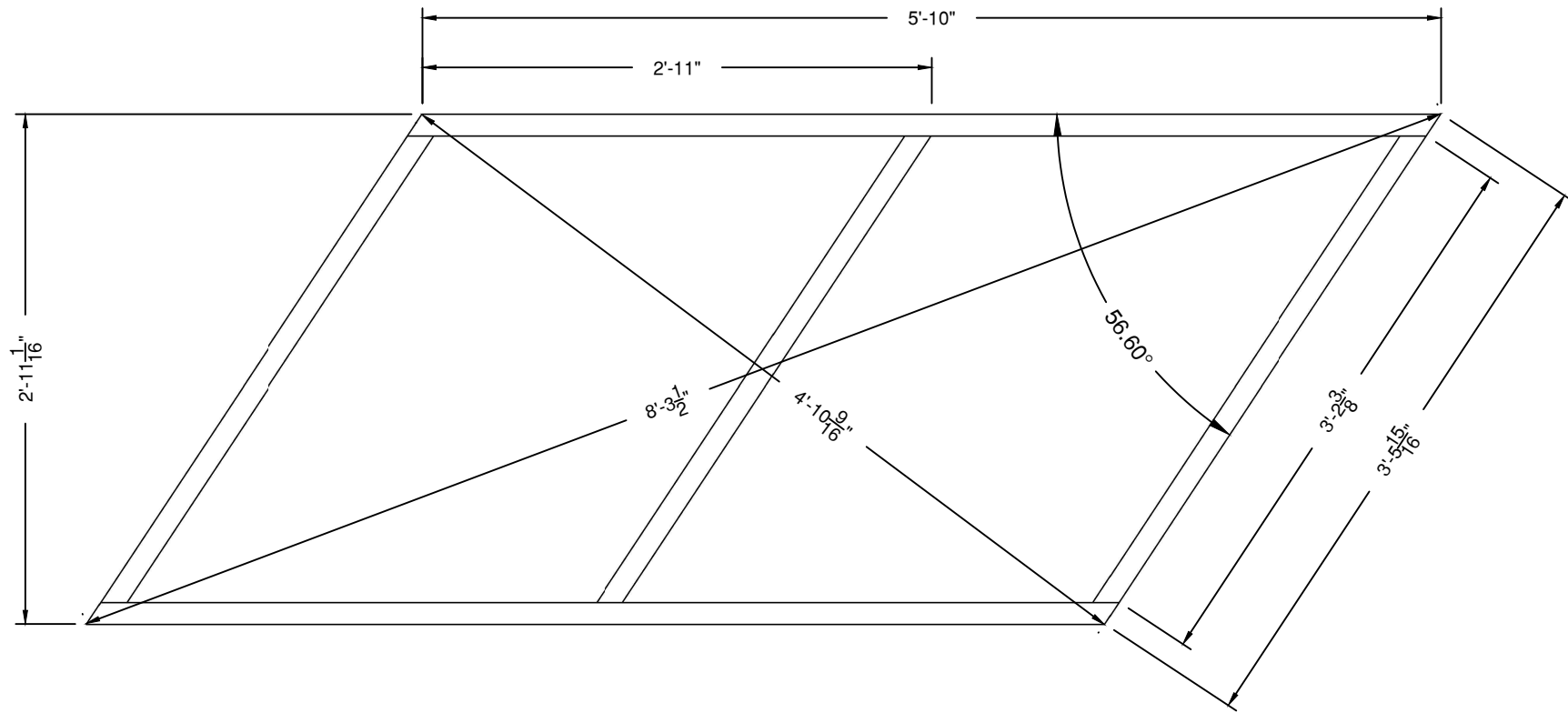

1
101 LANDING PLATFORM AND BASE FRAME TOP VIEW
 1.5"x.065 SQ TUBE CONST. 1" = 1'
 BUILD 4
 GRIND ALL FACE WELDS

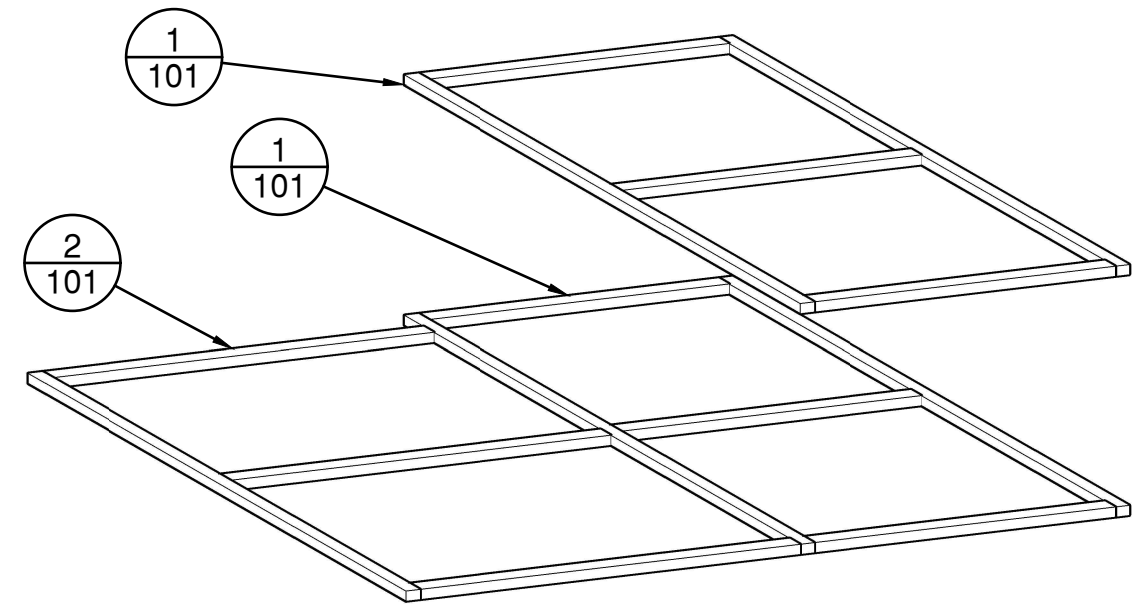

3
101 LANDING PLATFORM AND BASE FRAME (W/O LEGS) RIGHT ISO VIEW
 1.5"x.065 SQ TUBE CONST. 1" = 1'

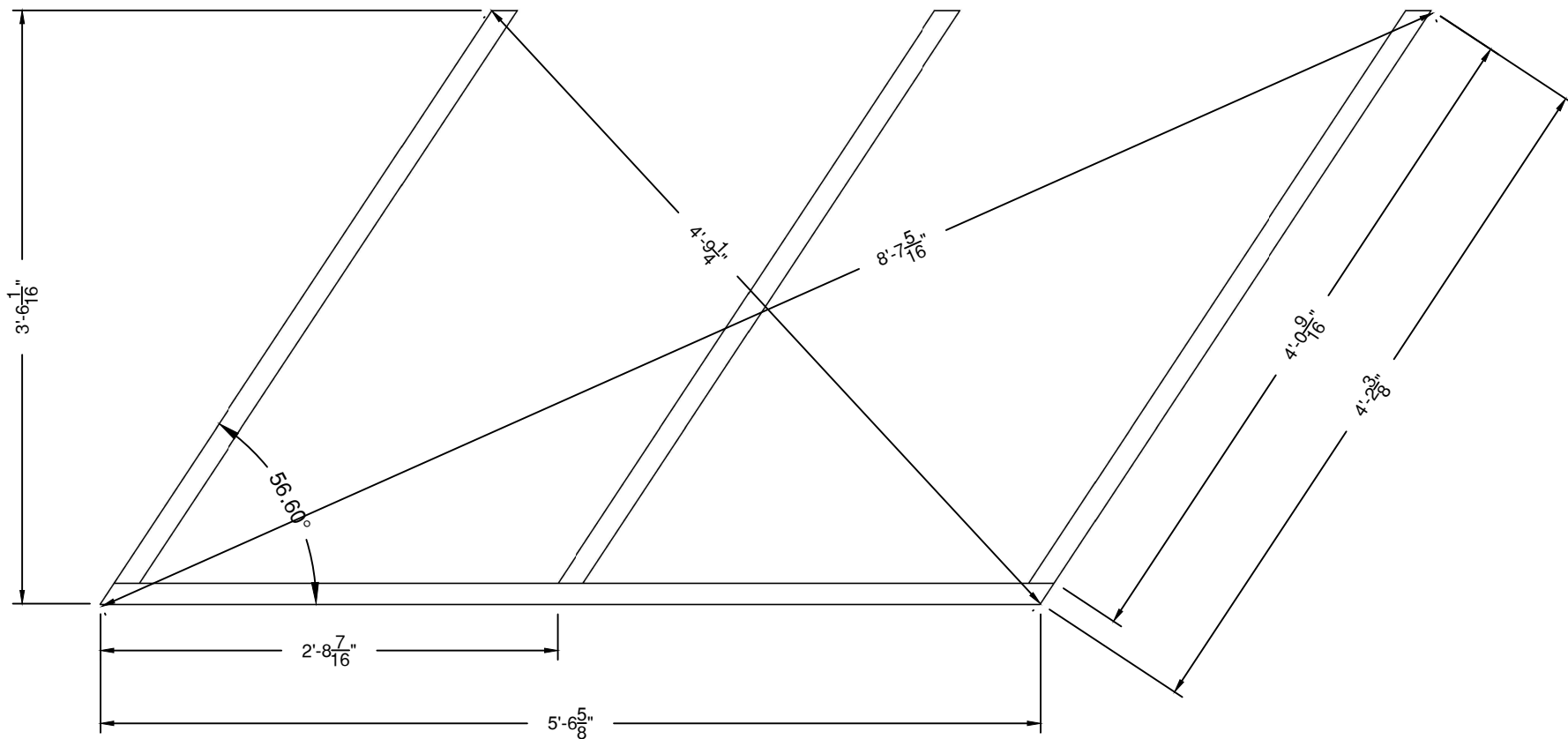

2
101 STAIR BASE TOP VIEW
 1.5"x.065" SQ TUBE CONST. 1" = 1'
 BUILD 2
 GRIND ALL FACE WELDS

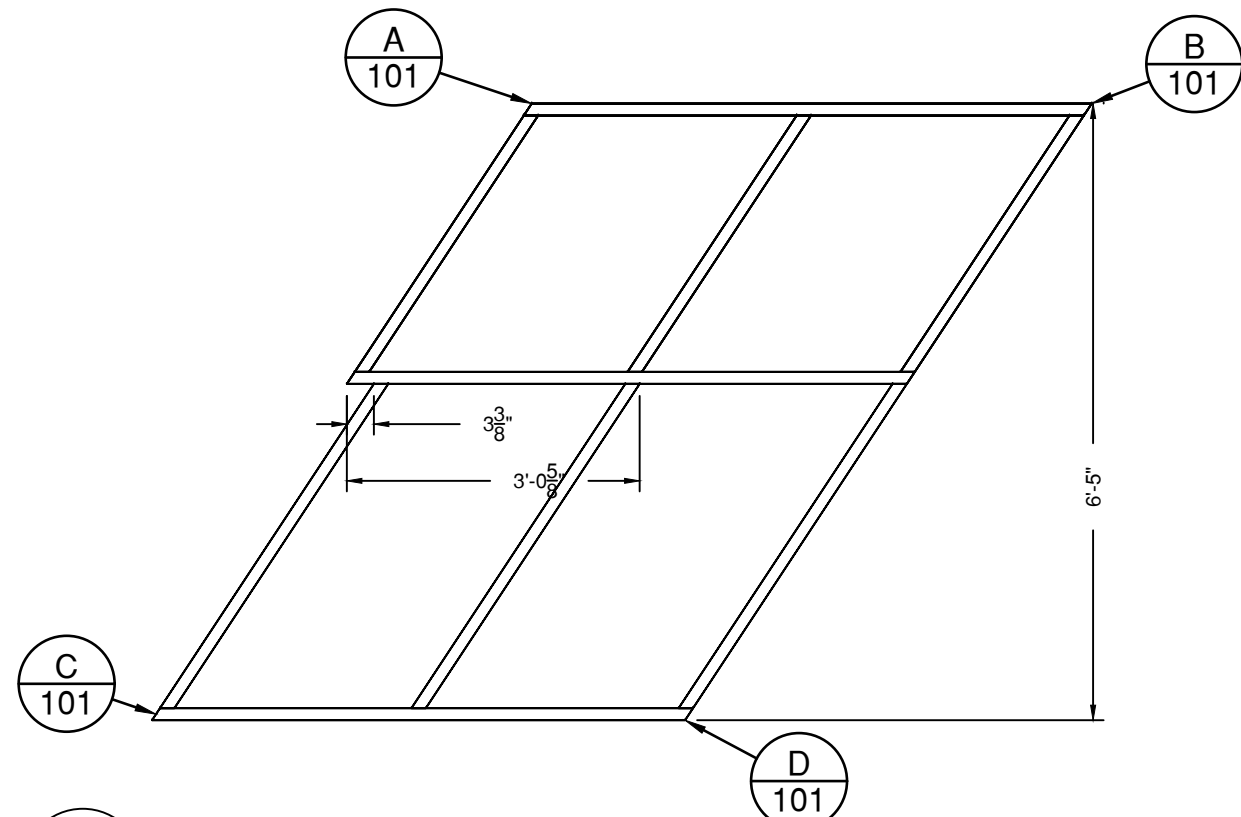

4
101 BASE ASSEMBLY TOP VIEW
 GRIND ALL FACE WELDS 1/2" = 1'
 DIAGONAL MEASUREMENT FOR A -> D IS 6'-7-7/16"
 DIAGONAL MEASUREMENT FOR B -> C IS 11'-8-1/2"
 BUILD 2
 ADD 1/2" PLY TACK STRIPS ON THE BOTTOM OF FRAME (R & R)

DS STAIRS
 LANDING & BASE

DIRECTOR: BRAD CARROL
 DESIGNER: JASON LAJKA
 TECH DIRECTOR: T. FAGERHOLM
 DWG BY: MDB DATE: 4/29/2019
 INVENTORY CODE: JO - DSS
 FILE: JO- 100- DS STAIRS

BUILD TIME

DATE	HOURS (Closest # Hour)

MATERIALS USED

MATERIAL	QUANTITY

SCRAP USED

MATERIAL	QUANTITY

SCALE: AS NOTED

101

JOSEPH

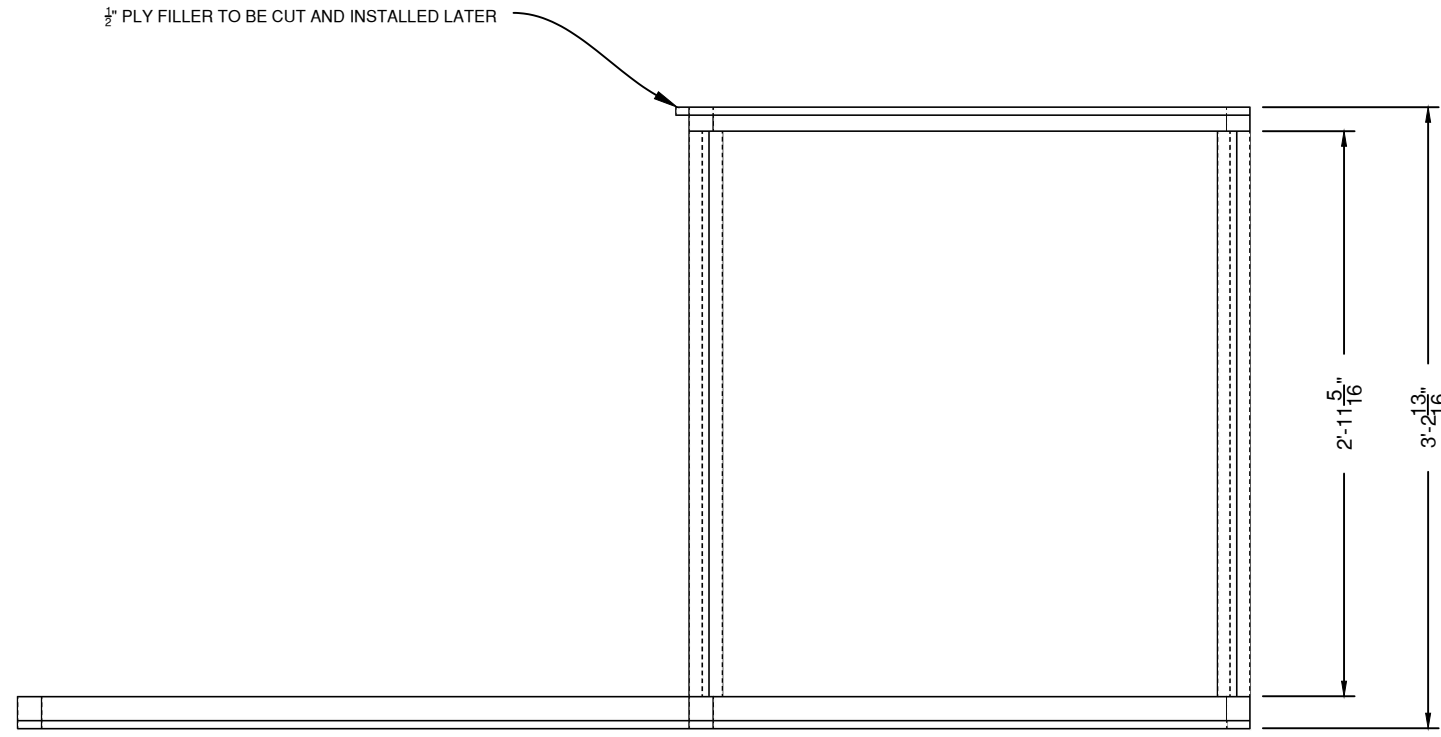

1 LANDING PLATFORM AND BASE WITH LEGS SIDE VIEW
102 1.5"x.065 SQ TUBE CONST. 1" = 1'
 NEED 6 LEGS PER STAIR UNIT, 12 LEGS TOTAL

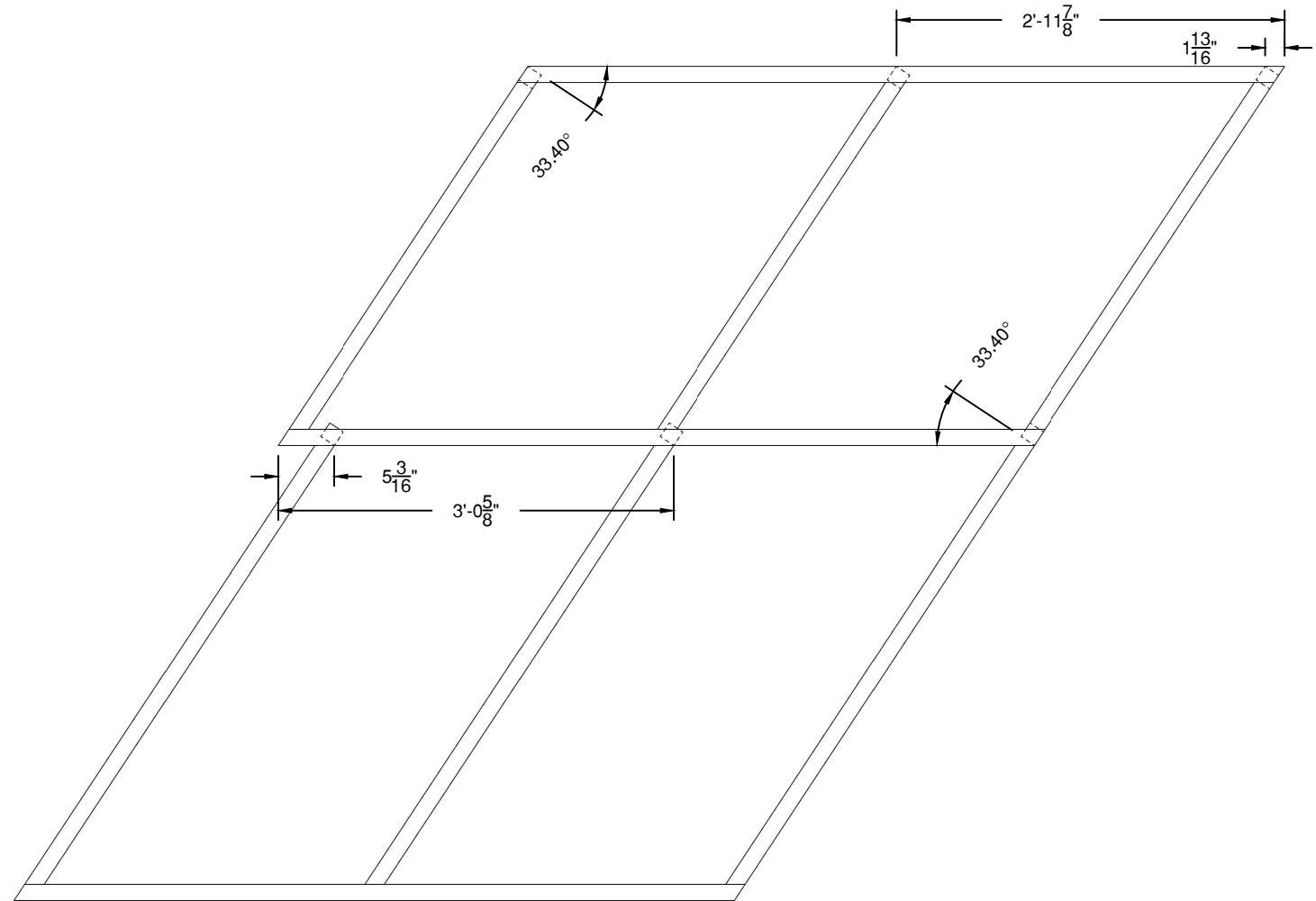

2 LEG PLACEMENT TOP VIEW
102 ADD LEGS TO ONE SET OF FRAMES, THEN R & R 3/4" = 1'

DS STAIRS

STAIR LEGS

DIRECTOR:	BRAD CARROL
DESIGNER:	JASON LAJKA
TECH DIRECTOR:	T. FAGERHOLM
DWG BY:	MDB
DATE:	4/30/2019
INVENTORY CODE:	JO - DSS
FILE:	JO- 100- DS STAIRS

BUILD TIME

DATE	HOURS (Closest # Hour)

MATERIALS USED

MATERIAL	QUANTITY

SCRAP USED

MATERIAL	QUANTITY

SCALE: AS NOTED

102

JOSEPH

DS STAIRS
 STRINGERS

DIRECTOR: BRAD CARROL
 DESIGNER: JASON LAJKA
 TECH DIRECTOR: T. FAGERHOLM
 DWG BY: MDB DATE: 4/30/2019
 INVENTORY CODE: JO - DSS

BUILD TIME	
DATE	HOURS (Closest Hour)

MATERIALS USED	
MATERIAL	QUANTITY

SCRAP USED	
MATERIAL	QUANTITY

SCALE: AS NOTED

103

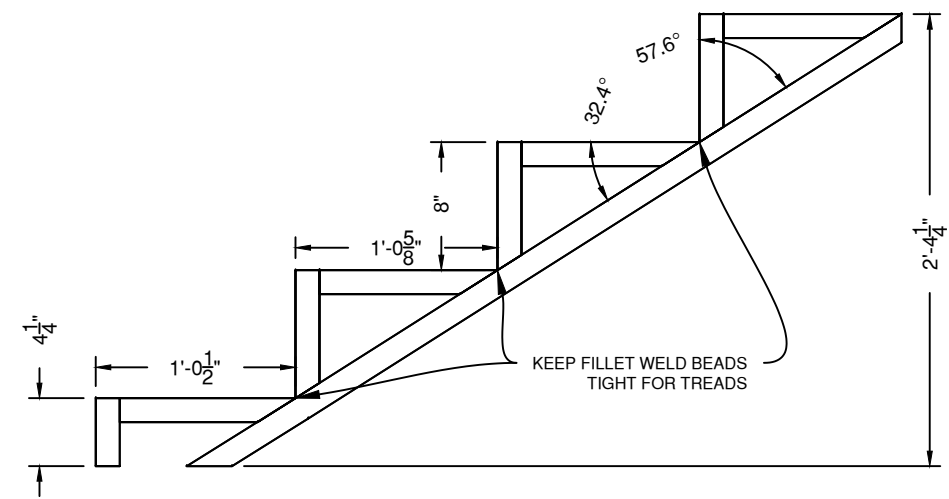

1 STINGERS SIDE VIEW
 103 1.5"x.065 SQ TUBE CONST.
 BUILD 6
 WELD ALL FILLET WELDS
 1" = 1'

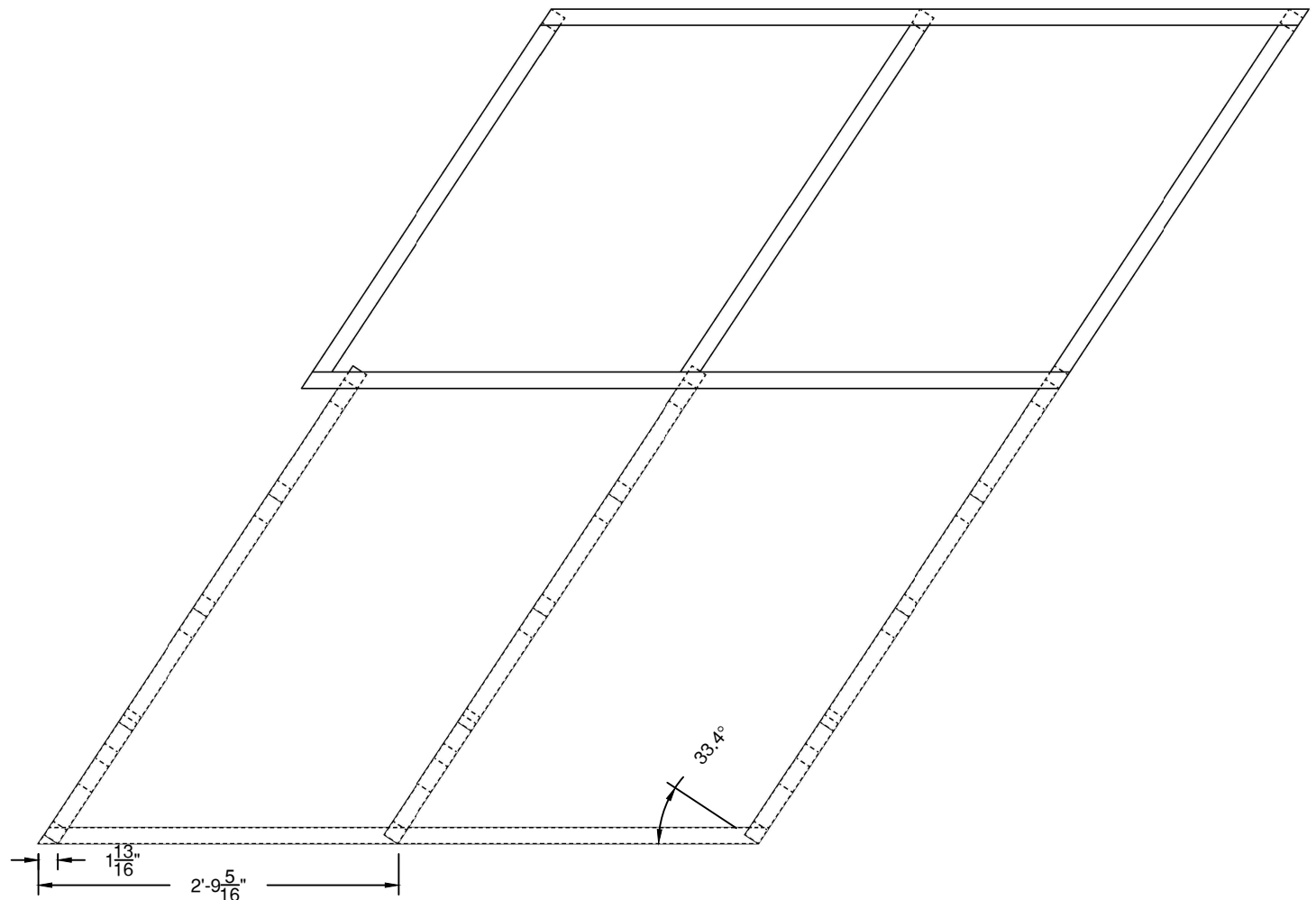

3 STRINGER PLACEMENT TOP VIEW
 103 1.5"x.065 SQ TUBE CONST.
 FILLET WELD 2 SIDES
 3/4" = 1'

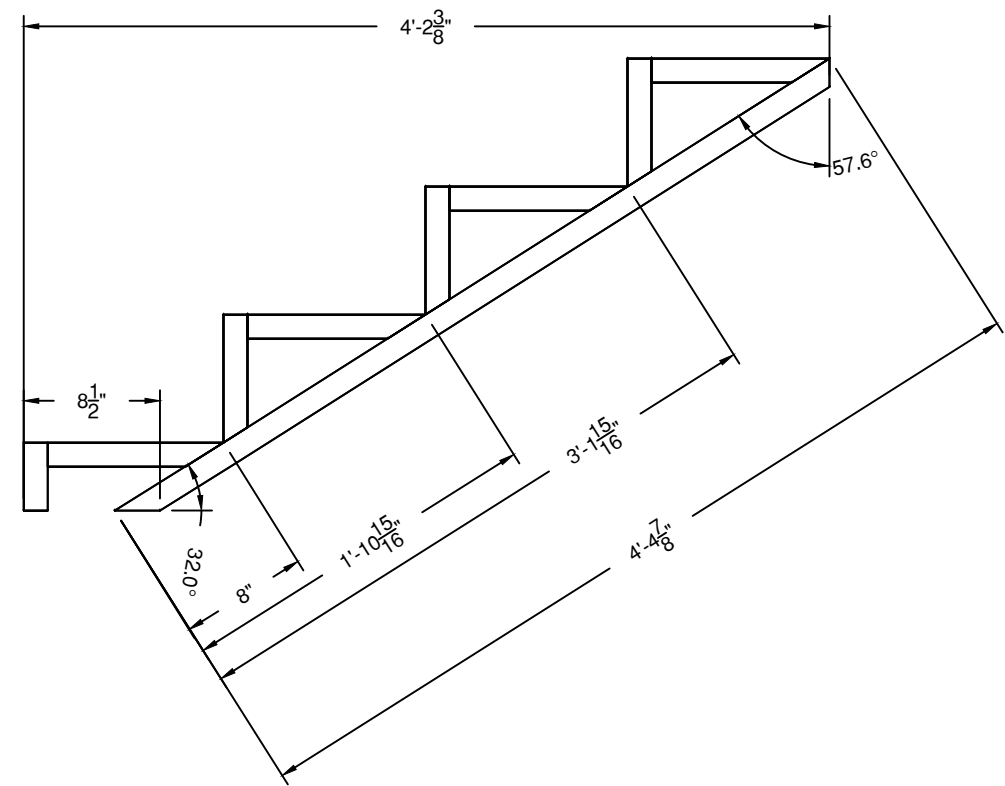

2 STINGERS (CONT.) SIDE VIEW
 103 1.5"x.065 SQ TUBE CONST.
 1" = 1'

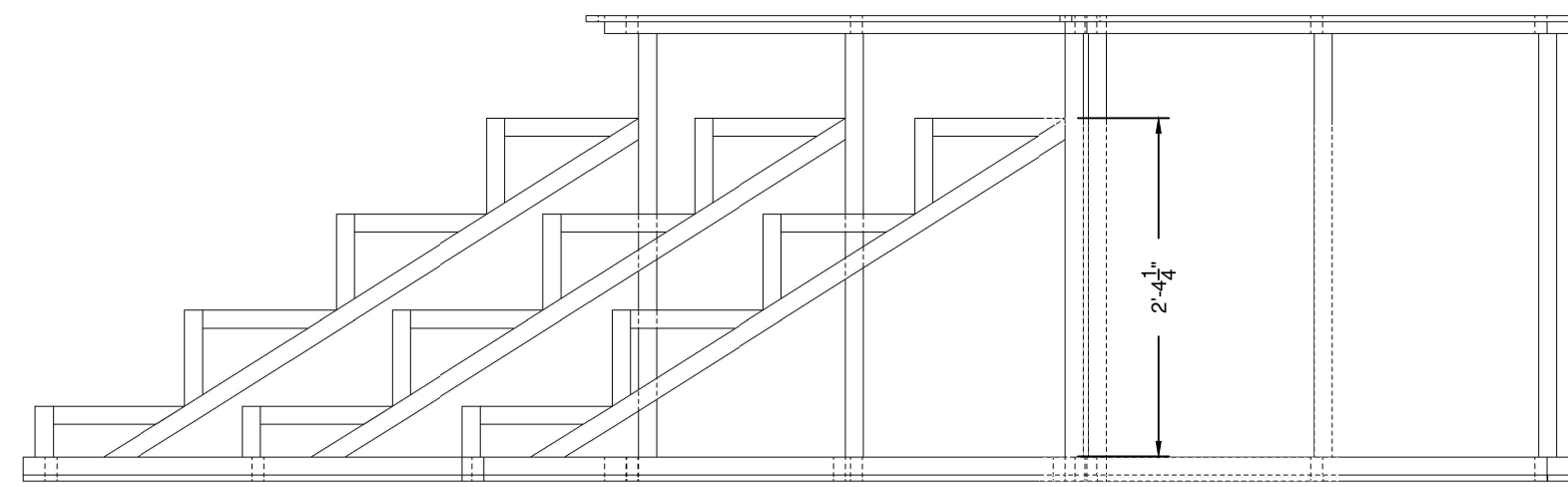

4 STINGER PLACEMENT (CONT.) SIDE VIEW
 103 1.5"x.065 SQ TUBE CONST.
 FILLET WELD 2 SIDES
 3/4" = 1'

JOSEPH

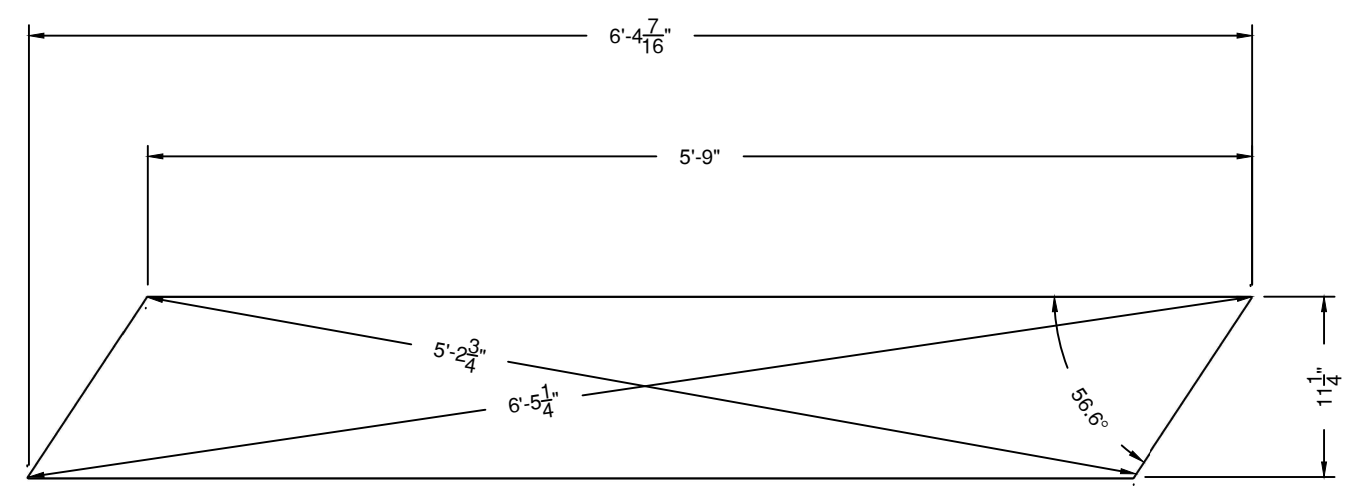

1 STAIR TREADS TOP VIEW
 104 2"x12" CONST. 1" = 1'
 NEED 4 TREADS PER UNIT, 8 TOTAL

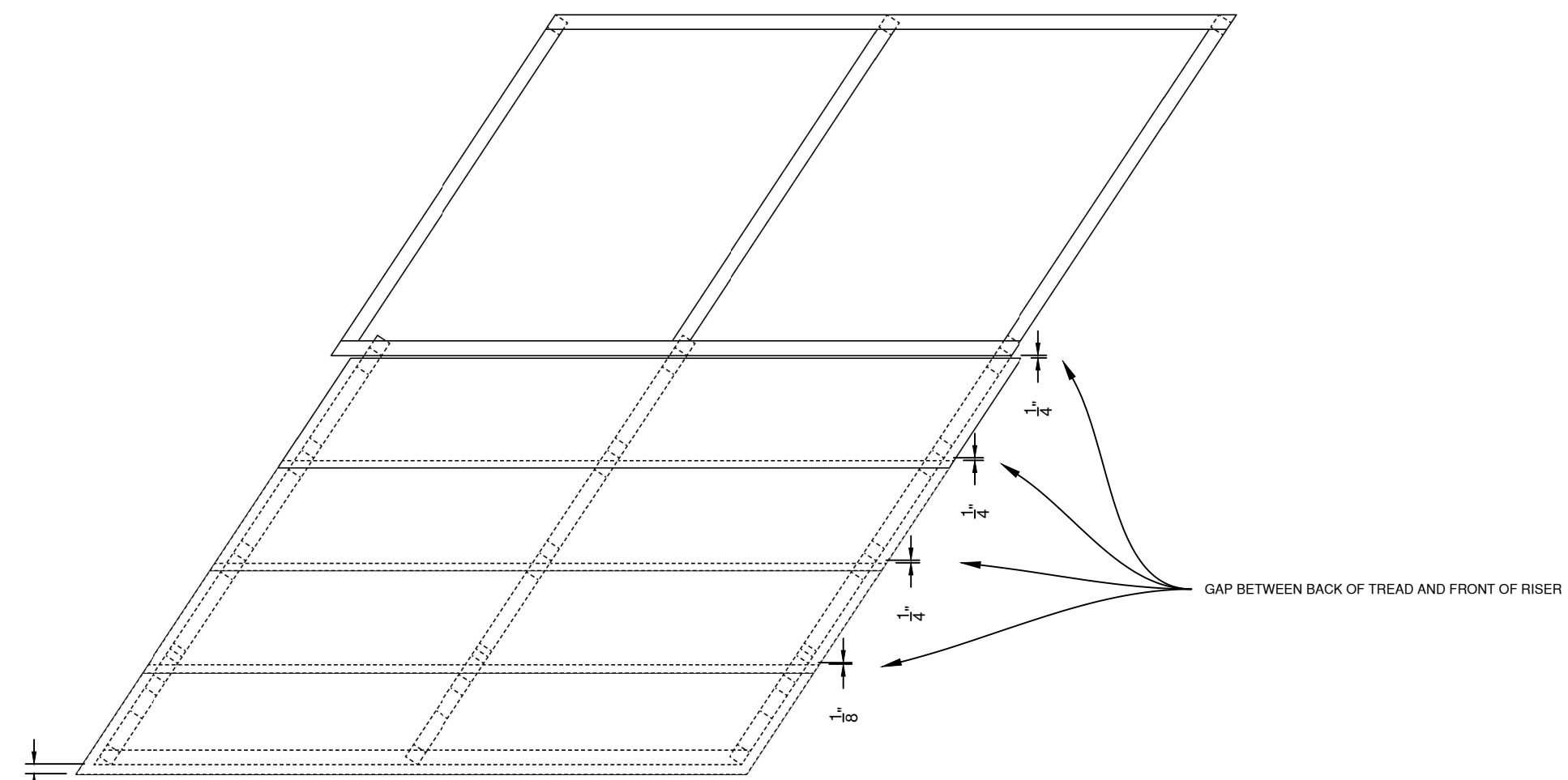

2 TREAD PLACEMENT TOP VIEW
 102 TEK SCREW 3/4" = 1'
 1" OVERHANG ON ALL SIDES
 REVERSE AND REPEAT FOR SECOND STAIR UNIT

DS STAIRS

STAIR TREADS

DIRECTOR: BRAD CARROL
 DESIGNER: JASON LAJKA
 TECH DIRECTOR: T. FAGERHOLM
 DWG BY: MDB DATE: 4/30/2019
 INVENTORY CODE: JO - DSS
 FILE: JO- 100- DS STAIRS

BUILD TIME

DATE	HOURS (Closest # Hour)

MATERIALS USED

MATERIAL	QUANTITY

SCRAP USED

MATERIAL	QUANTITY

SCALE: AS NOTED

JOSEPH

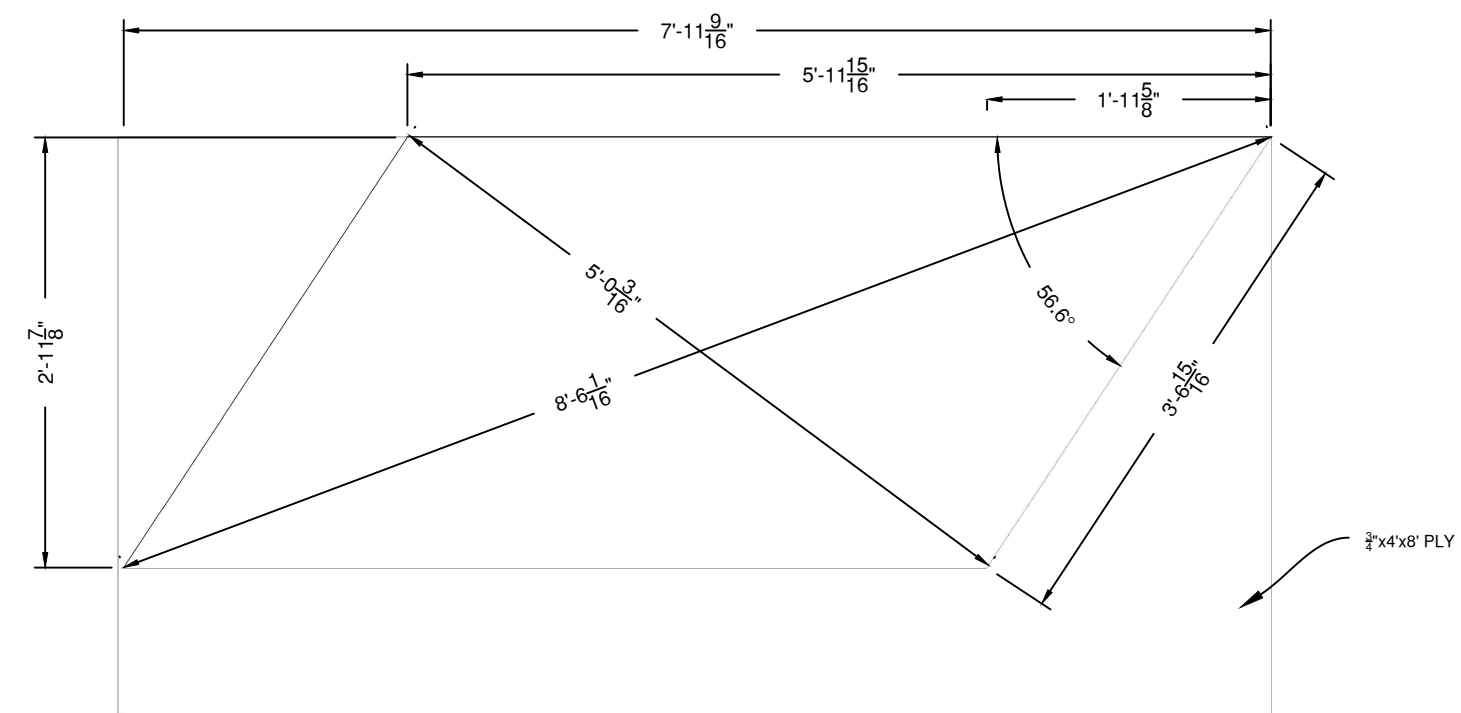

1 PLATFORM LID TOP VIEW
 105 3/4" CDX PLY CONST. 3/4" = 1'
 CUT 2

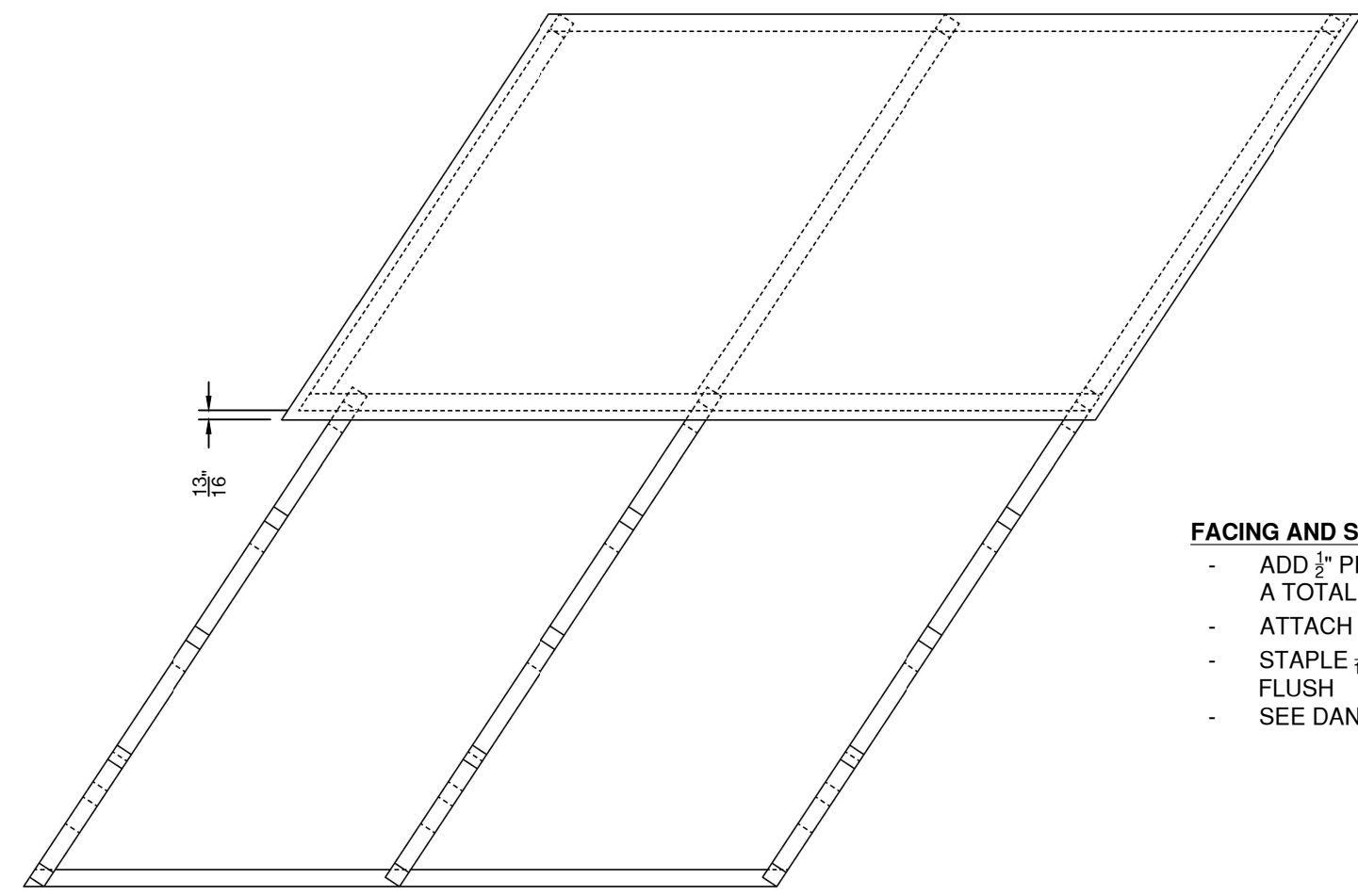

2 PLATFORM LID PLACEMENT TOP VIEW
 105 13/16" OVERHANG ON THREE SIDES, FLUSH TO THE BACK 3/4" = 1'
 REVERSE AND REPEAT FOR THE SECOND UNIT
 TEK SCREW TO FRAME

- FACING AND SKINNING NOTES**
- ADD 1/2" PLY STRIPS TO UNDERSIDE OF PLY LIP TO CREATE A TOTAL THICKNESS OF 1-1/4"
 - ATTACH 3/16" MASO RIPPED TO 1-1/4" FOR FACING
 - STAPLE 3/16" MASO SKIN TO THE TOP OF 3/4" PLY LID, ROUTE FLUSH
 - SEE DANIEL FOR ADDITIONAL QUESTIONS

DS STAIRS	
PLATFORM LID	
DIRECTOR: BRAD CARROL	
DESIGNER: JASON LAJKA	
TECH DIRECTOR: T. FAGERHOLM	
DWG BY: MDB	DATE: 4/30/2019
INVENTORY CODE: JO - DSS	
FILE: JO- 100- DS STAIRS	
BUILD TIME	
DATE	HOURS (Closest 1/2 Hour)
MATERIALS USED	
MATERIAL	QUANTITY
SCRAP USED	
MATERIAL	QUANTITY
SCALE:	AS NOTED

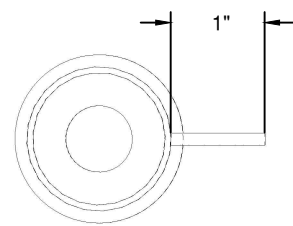

NOTES

- DRILL $\frac{3}{16}$ " HOLE IN THE CENTER OF THE 1" x 1 1/2" TABS
- ONCE WELDED GRIND THE $\frac{5}{8}$ " WASHER FLUSH TO THE MECHANICAL TUBE
- BUILD 2

1 TOP VIEW
 106 MATERIALS NOTED IN THE ISO DRAWING 6" = 1'
 CENTER TABS ON THE MECHANICAL TUBE
 CENTER MECHANICAL TUBE ON WASHER

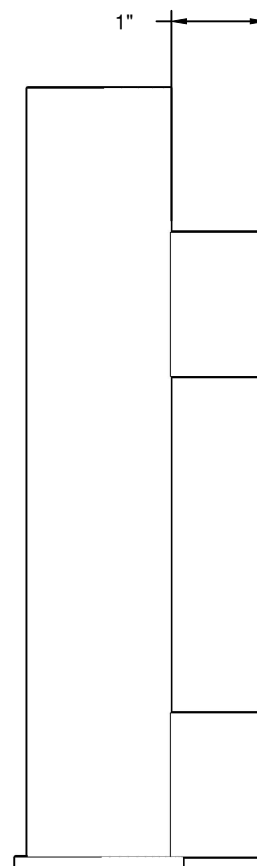
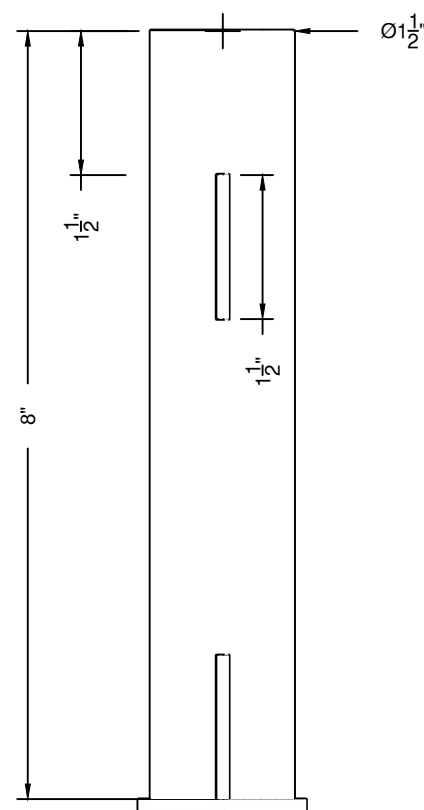

3 SIDE VIEW
 106 MATERIALS NOTED IN THE ISO DRAWING 6" = 1'

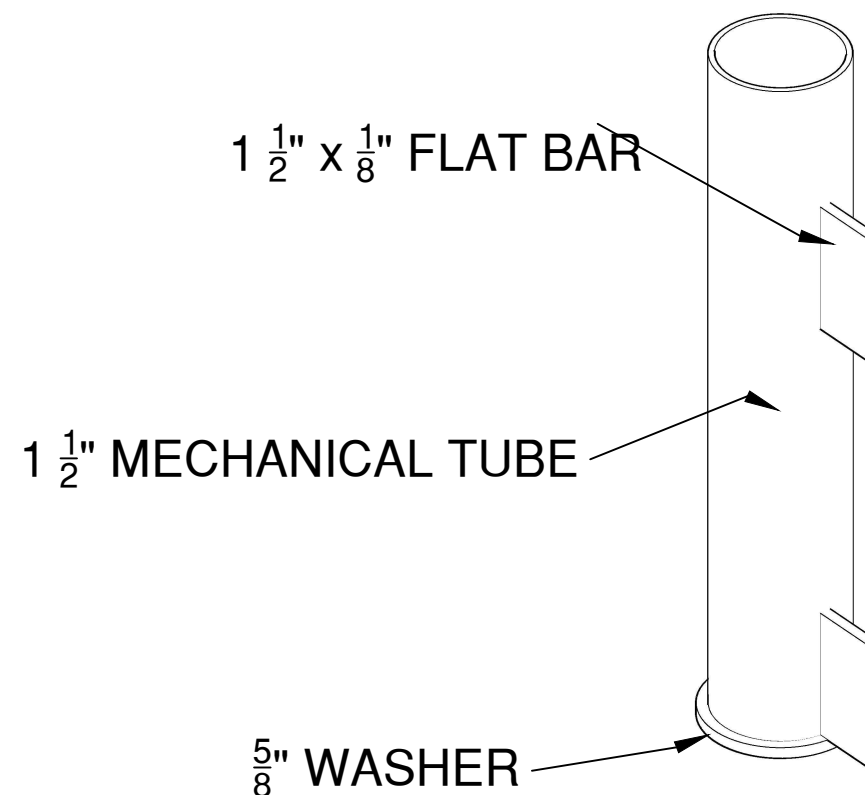

2 FRONT VIEW
 106 MATERIALS NOTED IN THE ISO DRAWING 6" = 1'
 CENTER TABS ON THE MECHANICAL TUBE
 CENTER MECHANICAL TUBE ON WASHER

4 LEFT ISO VIEW
 106 6" = 1'

DS STAIRS	
PIPE SLEEVES	
DIRECTOR: BRAD CARROL	
DESIGNER: JASON LAJKA	
TECH DIRECTOR: T. FAGERHOLM	
DWG BY: MDB	DATE: 05/09/2019
INVENTORY CODE: JO - DSS	
FILE: JO- 100- DS STAIRS	
BUILD TIME	
DATE	HOURS (Closest # Hour)
MATERIALS USED	
MATERIAL	QUANTITY
SCRAP USED	
MATERIAL	QUANTITY
SCALE: AS NOTED	

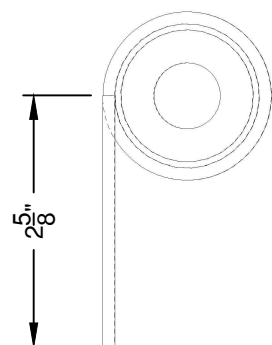

NOTES

- DRILL $\frac{1}{8}$ " HOLE (CENTERED) $\frac{3}{4}$ " FROM THE EDGE OF $1\frac{1}{2}$ " x $\frac{1}{8}$ " TABS
- ONCE WELDED GRIND THE $\frac{5}{8}$ " WASHER FLUSH TO THE MECHANICAL TUBE
- BUILD 2 (REVERSE AND REPEAT THE SECOND ONE)

1 TOP VIEW
 106 MATERIALS NOTED IN THE ISO DRAWING 6" = 1'
 CENTER TABS ON THE MECHANICAL TUBE
 CENTER MECHANICAL TUBE ON WASHER

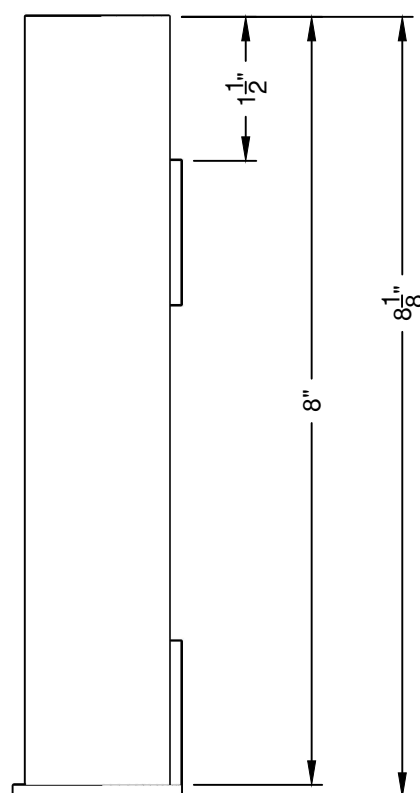

2 FRONT VIEW
 106 MATERIALS NOTED IN THE ISO DRAWING 6" = 1'
 CENTER MECHANICAL TUBE ON WASHER

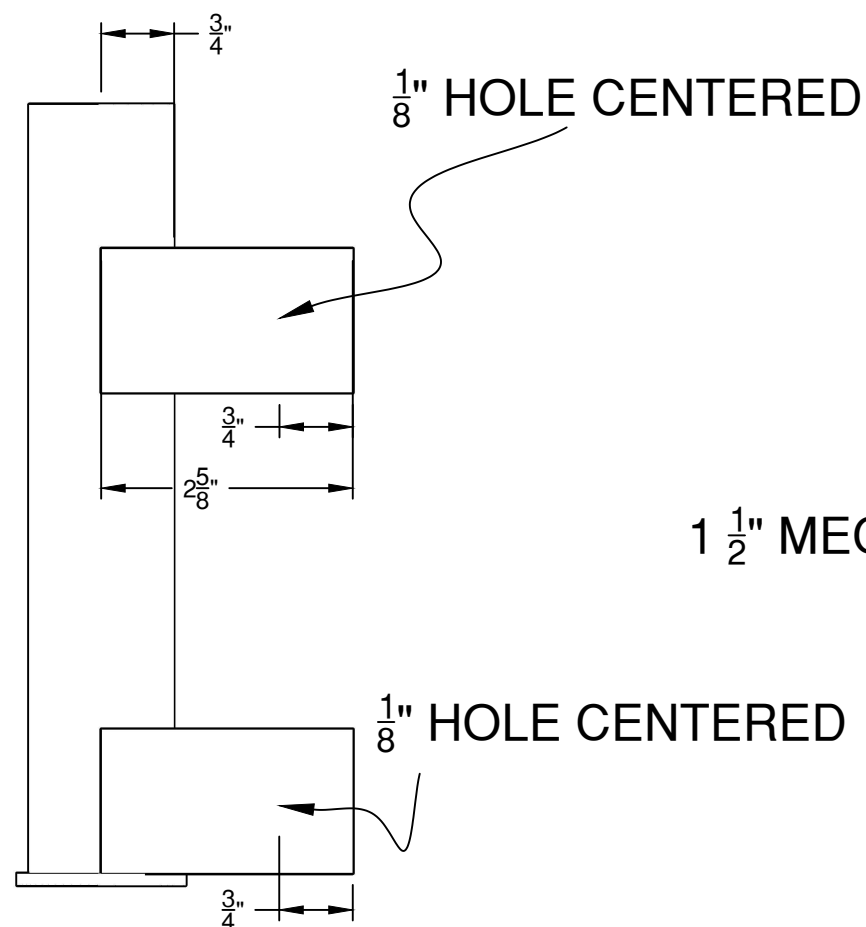

3 FRONT VIEW
 106 MATERIALS NOTED IN THE ISO DRAWING 6" = 1'
 CENTER TABS ON MECHANICAL TUBE

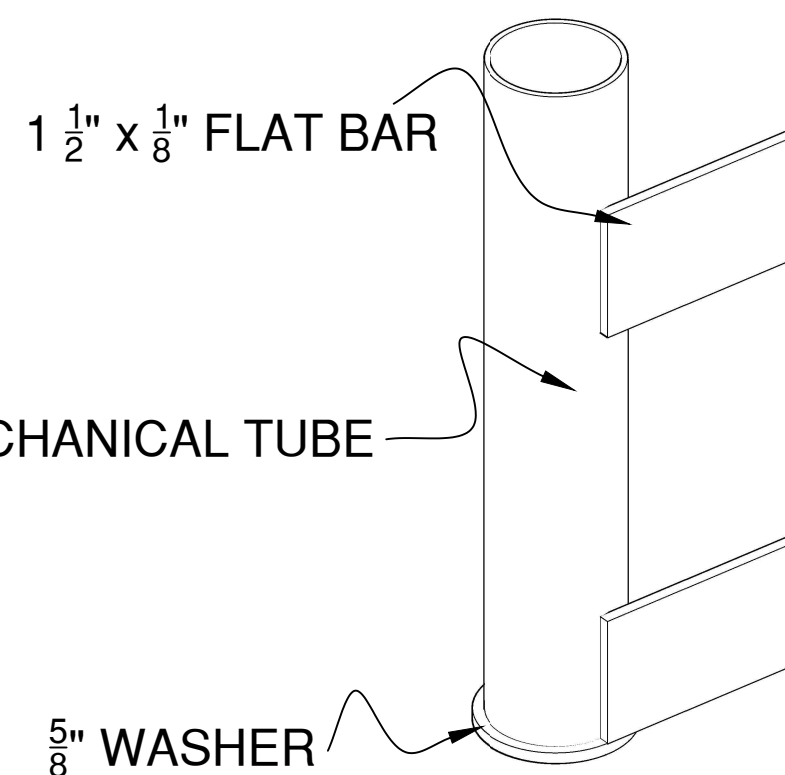

4 LEFT ISO VIEW
 106 6" = 1'

DS STAIRS	
PIPE SLEEVES	
DIRECTOR: BRAD CARROL	
DESIGNER: JASON LAJKA	
TECH DIRECTOR: T. FAGERHOLM	
DWG BY: MDB	DATE: 05/09/2019
INVENTORY CODE: JO - DSS	
FILE: JO- 100- DS STAIRS	
BUILD TIME	
DATE	HOURS (Closest # Hour)
MATERIALS USED	
MATERIAL	QUANTITY
SCRAP USED	
MATERIAL	QUANTITY
SCALE: AS NOTED	

JOSEPH

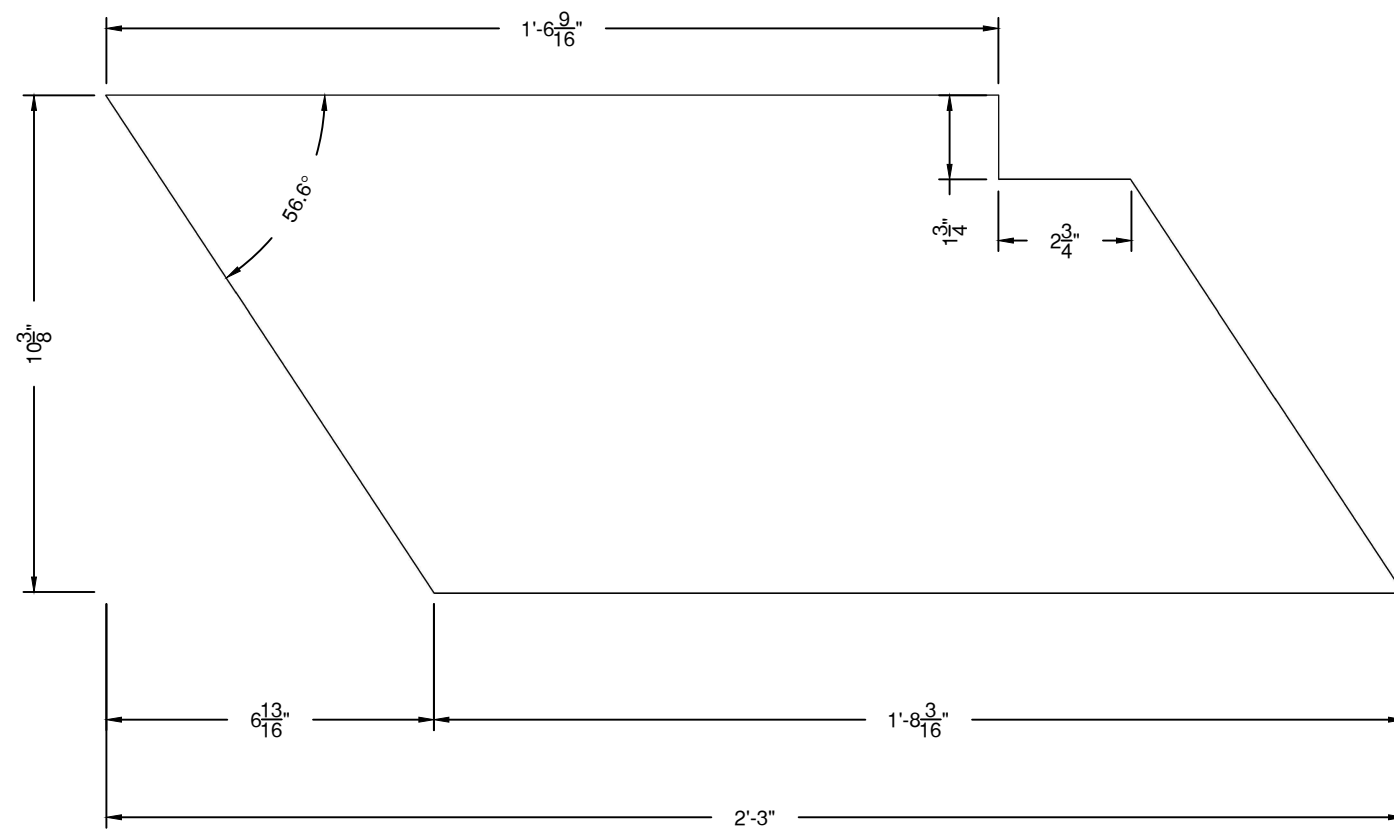

1 TOP VIEW: BATTERY BOX PLATE
108 3/4" PLY SCRAP
DOESN'T HAVE TO BE PRECISE
BUILD 2 (2ND IS R&R)

3" = 1'-0"

DS STAIRS
BATTERY PLATES

DIRECTOR:	BRAD CARROL
DESIGNER:	JASON LAJKA
TECH:	T. FAGERHOLM
DWG BY:	TKF
DATE:	05/21/2019
INVENTORY CODE:	JO - DSS
FILE:	JO- 100- DS STAIRS

BUILD TIME

DATE	HOURS (Closest 1/2 hour)

MATERIALS USED

MATERIAL	QUANTITY

SCRAP USED

MATERIAL	QUANTITY

SCALE: 3"=1'-0"

108

JOSEPH

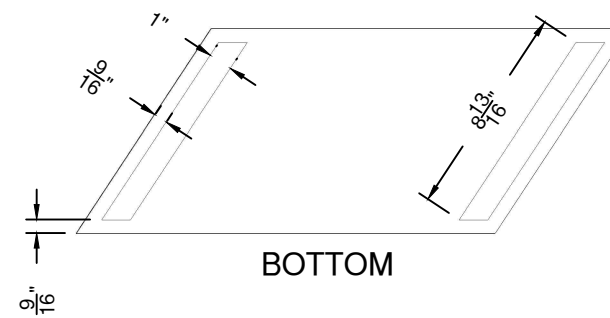
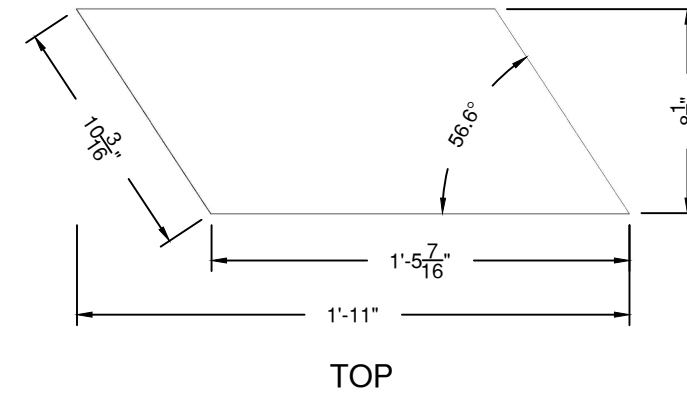
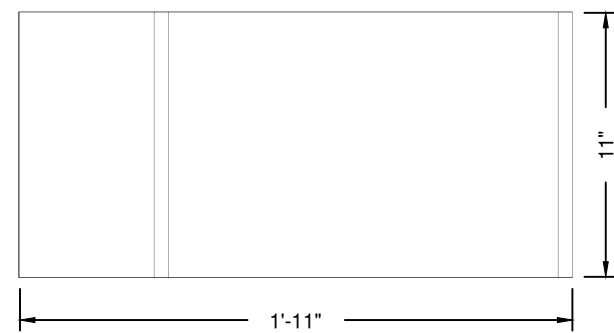
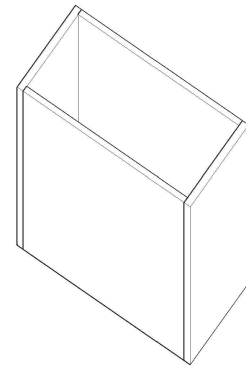
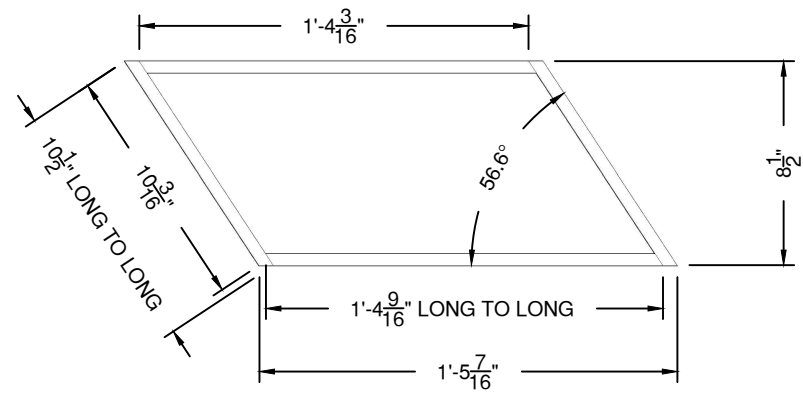

1 ORTHOGRAPHIC: BATTERY BOX
109 1/2" PLY SCRAP (SANDE OR CDX) 1-1/2" = 1'-0"
GLUE AND NC STAPLE
BUILD 2 (2ND IS R&R)
ITS JUST A BATTERY BOX, DOESN'T HAVE TO BE SUPER ACCURATE

2 TOP & BOTTOM VIEWS: BATTERY BOX LID
109 1/2" PLY SCRAP (SANDE OR CDX) 1-1/2" = 1'-0"
GLUE AND NC STAPLE
BUILD 2 (2ND IS R&R)
STRIPS ON BOTTOM ARE INSET TO CENTER LID ON BOX OPENING

DS STAIRS

BATTERY BOX

DIRECTOR:	BRAD CARROL
DESIGNER:	JASON LAJKA
TECH:	T. FAGERHOLM
DWG BY:	TKF
DATE:	05/30/2019
INVENTORY CODE:	JO - DSS
FILE:	JO- 100- DS STAIRS

BUILD TIME

DATE	HOURS (Closest 1/4 hour)

MATERIALS USED

MATERIAL	QUANTITY

SCRAP USED

MATERIAL	QUANTITY

SCALE: 1-1/2"=1'-0"

109

JOSEPH

NOTES

- BUILD 2 (REVERSE AND REPEAT THE SECOND ONE)
- ONCE WELDED GRIND THE $\frac{5}{8}$ " WASHER FLUSH TO THE MECHANICAL TUBE

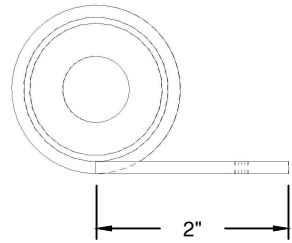

1 TOP VIEW
110 MATERIALS NOTED IN THE ISO DRAWING 6" = 1'
CENTER TABS ON THE MECHANICAL TUBE
CENTER MECHANICAL TUBE ON WASHER

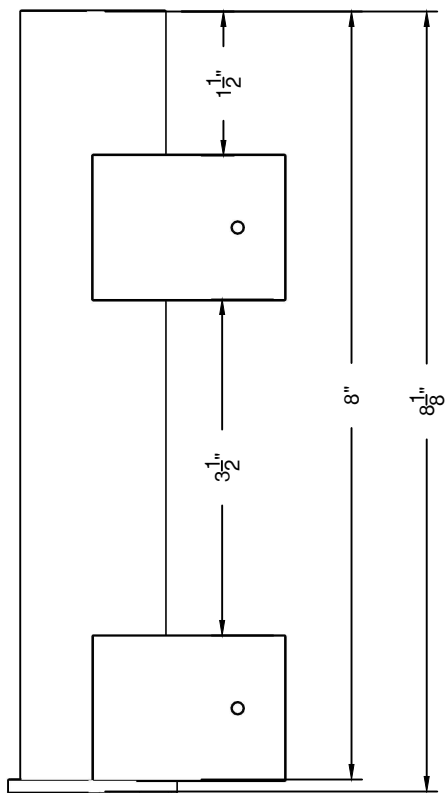

2 FRONT VIEW
110 MATERIALS NOTED IN THE ISO DRAWING 6" = 1'
CENTER MECHANICAL TUBE ON WASHER

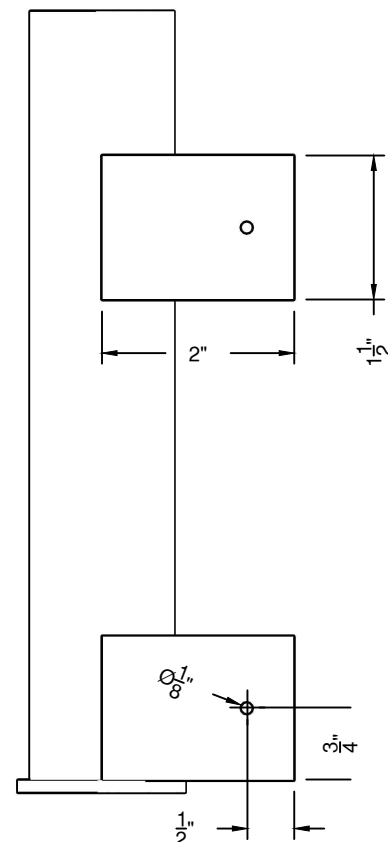

3 FRONT VIEW: TAB DIMS AND HOLE PLACEMENT
110 MATERIALS NOTED IN THE ISO DRAWING 6" = 1'
CENTER TABS ON MECHANICAL TUBE

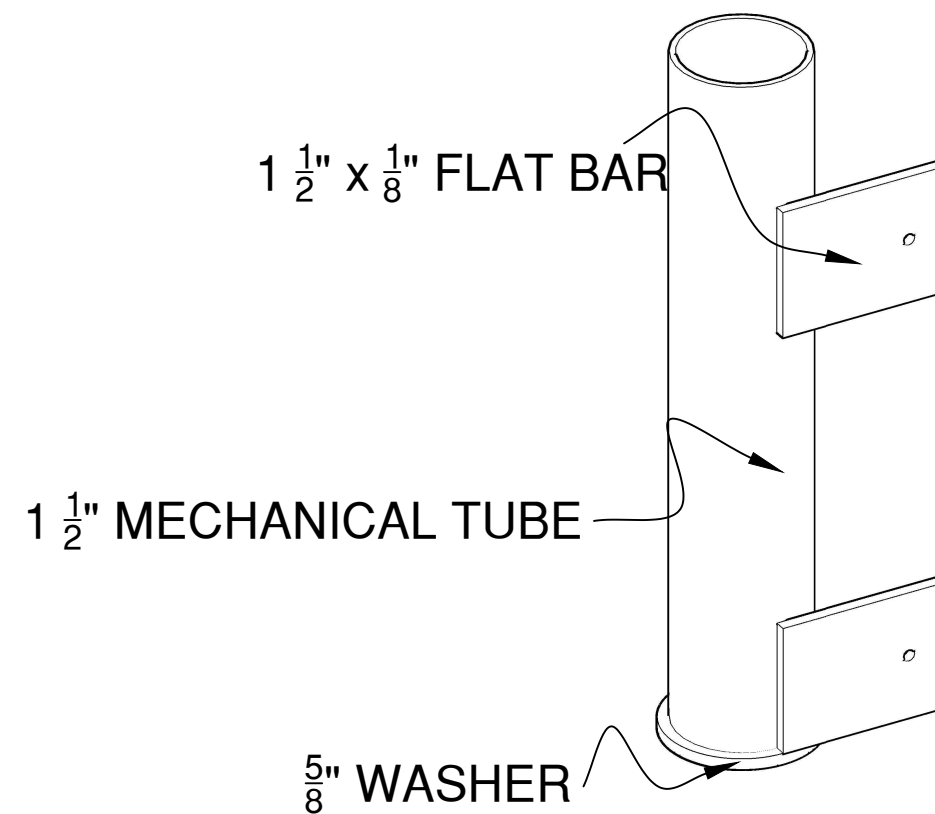

4 LEFT ISO VIEW
110 6" = 1'

DS STAIRS

PIPE SLEEVES

DIRECTOR:	BRAD CARROL
DESIGNER:	JASON LAJKA
TECH DIRECTOR:	T. FAGERHOLM
DWG BY:	MDB
DATE:	06/07/2019
INVENTORY CODE:	JO - DSS
FILE:	JO- 100- DS STAIRS

BUILD TIME

DATE	HOURS (Closest 1/4 hour)

MATERIALS USED

MATERIAL	QUANTITY

SCRAP USED

MATERIAL	QUANTITY

SCALE: AS NOTED

110

JOSEPH

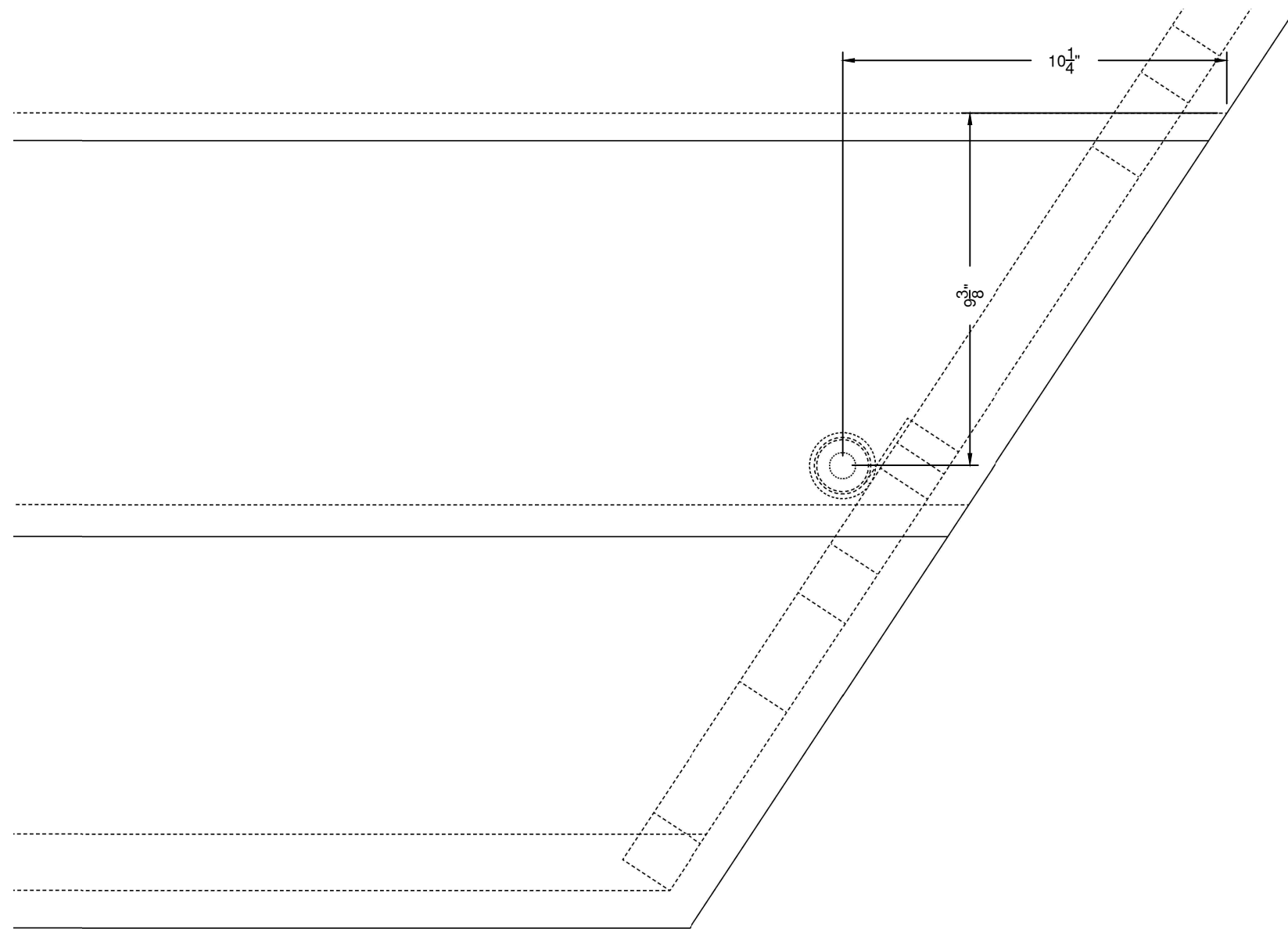

- 1 TOP VIEW: POINTS FROM TREAD
- 111 USE 1-5/8" HOLE SAW 3/4" = 1'
- REVERSE AND REPEAT FOR THE SECOND UNIT
- TEK SCREW TO FRAME
- SEE CHYNNA FOR QUESTIONS
- TABS ARE FLUSH TO STEEL, TOP IS AGAINST TREAD

DS STAIRS

FAN SLEEVES

DIRECTOR:	BRAD CARROL
DESIGNER:	JASON LAJKA
TECH DIRECTOR:	T. FAGERHOLM
DWG BY:	MDB
DATE:	6/10/2019
INVENTORY CODE:	JO - DSS
FILE:	JO- 100- DS STAIRS

BUILD TIME

DATE	HOURS (Closest 1/2 hour)

MATERIALS USED

MATERIAL	QUANTITY

SCRAP USED

MATERIAL	QUANTITY

SCALE: AS NOTED

111